

PLAT SHOWING
 NORTH PARK NO. 2 SUBDIVISION
 A SUBDIVISION IN
 THE SE1/4 & SW1/4, SECTION 5, T.10.S., R.17E., B.M.
 TWIN FALLS, TWIN FALLS COUNTY, IDAHO
 1977

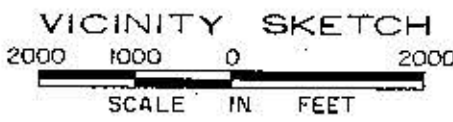
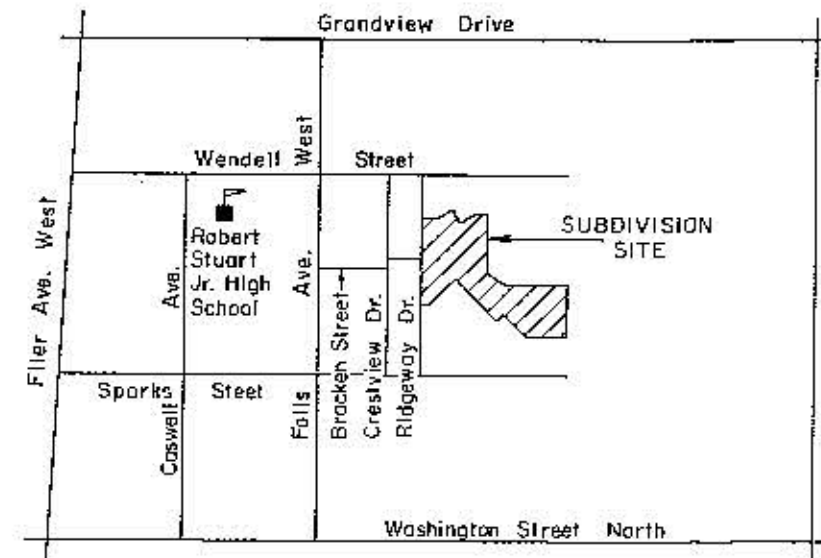
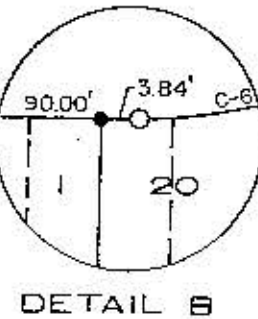
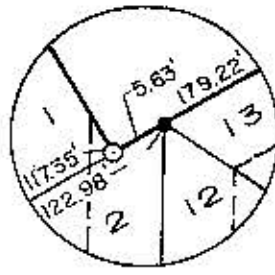
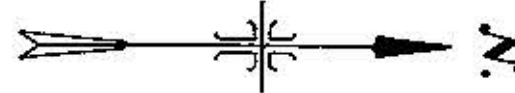
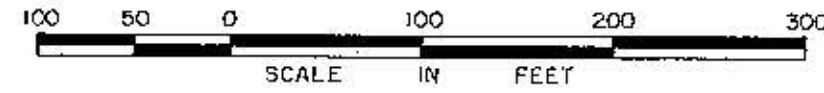

CURVE DATA

CURVE	R	A	T	L	CH. L.	CH. BEARING
C-1	172.00	3° 22' 07"	43.14	95.91	94.62	N.15° 12' 53" W.
C-2	123.00	45° 00' 00"	51.75	98.18	95.97	N.22° 01' 50" W.
C-3	20.00	90° 00' 00"	20.00	0.00	0.00	N.00° 00' 00" W.
C-4	200.00	27° 16' 03"	48.61	95.18	94.29	N.13° 09' 51" W.
C-5	200.00	4° 06' 04"	7.61	14.32	14.31	N.28° 50' 58" W.
C-6	225.00	17° 15' 40"	34.15	67.78	67.53	N. 8° 09' 40" W.
C-7	20.00	85° 12' 29"	17.75	25.04	24.56	N.24° 48' 42" E.
C-8	175.00	24° 03' 16"	37.28	73.47	72.92	N.75° 39' 34" E.
C-9	200.00	36° 38' 40"	66.23	127.91	125.74	N.72° 50' 50" E.
C-10	225.00	25° 00' 45"	49.91	98.23	97.45	N.77° 57' 47" E.
C-11	20.00	83° 32' 39"	17.90	29.50	28.67	N.72° 43' 17" W.
C-12	75.00	18° 22' 03"	12.16	22.11	21.00	N.81° 15' 39" E.
C-13	75.00	26° 34' 57"	17.72	34.80	34.49	N.88° 45' 38" E.
C-14	100.00	45° 00' 00"	41.42	78.54	76.94	N.67° 58' 10" E.
C-15	125.00	23° 25' 32"	32.82	64.20	63.49	N.78° 45' 24" E.
C-16	125.00	15° 34' 28"	17.05	33.98	33.87	N.53° 15' 24" E.
C-17	125.00	12° 00' 47"	13.15	26.21	26.16	N. 9° 52' 14" W.
C-18	20.00	84° 18' 04"	18.10	29.43	28.84	N.68° 40' 25" E.
C-19	125.00	38° 38' 04"	44.53	85.78	84.07	N.76° 43' 15" E.
C-20	20.00	48° 59' 41"	9.33	17.48	16.90	N.68° 28' 20" E.
C-21	50.00	82° 45' 38"	44.10	72.28	68.15	N. 8° 13' 13" E.
C-22	50.00	4° 13' 37"	29.59	53.44	50.82	N.24° 05' 15" W.
C-23	50.00	58° 04' 26"	27.76	50.68	48.74	N.53° 33' 44" E.
C-24	50.00	77° 51' 57"	40.39	67.55	67.84	N.78° 28' 07" W.
C-25	20.00	48° 59' 41"	9.33	17.45	16.90	N.64° 31' 09" W.
C-26	75.00	23° 43' 23"	18.97	39.04	38.60	N.75° 33' 29" E.
C-27	20.00	10° 10' 37"	26.15	35.21	31.77	N. 5° 03' 29" E.
C-28	100.00	45° 00' 00"	41.42	78.50	76.94	N.67° 58' 10" E.
C-29	125.00	18° 58' 19"	21.97	43.50	43.28	N.34° 31' 40" W.
C-30	100.00	13° 00' 05"	11.40	22.69	22.64	N.80° 01' 46" W.
C-31	20.00	49° 59' 41"	9.33	17.45	16.90	N.69° 31' 41" W.
C-32	40.00	58° 22' 02"	26.77	49.16	47.35	N.68° 12' 24" W.
C-33	50.00	58° 24' 33"	27.95	50.97	48.79	N. 8° 59' 09" W.
C-34	50.00	56° 45' 27"	27.01	49.53	47.93	N.48° 35' 51" W.
C-35	50.00	58° 09' 09"	24.47	45.51	43.26	N.76° 28' 50" W.
C-36	50.00	58° 20' 08"	26.77	49.16	47.21	N.23° 42' 12" W.
C-37	20.00	49° 59' 41"	9.33	17.45	16.90	N.19° 31' 58" W.
C-38	225.00	11° 14' 41"	32.15	46.15	44.09	N.85° 52' 23" W.
C-39	225.00	16° 29' 15"	32.50	64.55	64.33	N.25° 40' 10" W.
C-40	225.00	17° 23' 53"	34.33	68.32	68.00	N. 8° 08' 57" W.
C-41	200.00	45° 04' 50"	85.01	157.16	153.33	N.21° 59' 25" W.
C-42	175.00	38° 42' 11"	61.85	118.21	115.95	N.18° 48' 09" W.
C-43	20.00	38° 42' 11"	22.36	33.64	25.82	N.85° 20' 50" W.
C-44	100.00	44° 56' 10"	41.34	78.40	76.41	N.23° 00' 35" E.
C-45	125.00	44° 56' 10"	51.67	98.00	95.51	N.23° 00' 35" E.
C-46	150.00	23° 27' 39"	28.78	58.80	58.42	N.11° 48' 37" E.
C-47	150.00	32° 59' 13"	37.01	71.47	70.98	N.28° 02' 13" W.

NOTE:

1. There is hereby reserved along all lot frontages adjacent to streets, a 5' wide easement for public utilities.

LEGEND

- ⊙ Brass Cap
- 3/4" x 30" Steel Re-bar
- 5/8" x 30" Steel Re-bar
- 1/2" x 24" Steel Re-bar
- Public Utilities, Irrigation, and Drainage Easements 15' from exterior property lines and 7.5' from interior property lines, except as shown.

POINT OF BEGINNING

Twin Falls County, Idaho
 Recorded for:
 JUB ENG
 09:00:08 am May 01, 1977
 0000-714791

J-U-B ENGINEERS, INC.
 Engineers Planners
 Twin Falls, Idaho

GOLDEN VIEW SUBDIVISION NO. 2

