

LOCUST GROVE SUBDIVISION

THE GROVE ESTATES SUBDIVISION

S 89°32'58" E 633.82'

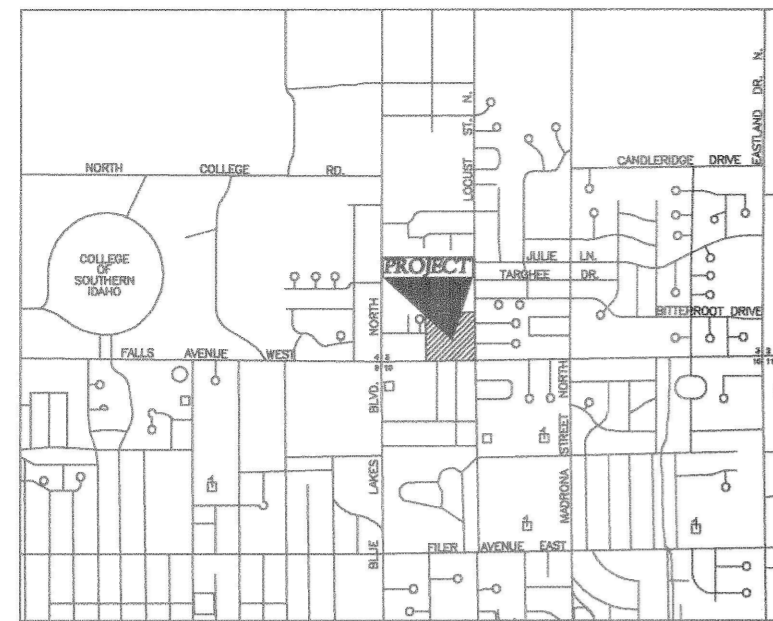

Vicinity N.T.S.

LINE TABLE		
LINE	LENGTH	BEARING
L1	16.57	S89°32'58"E
L2	2.40	S00°27'02"W
L3	130.44	S89°32'58"E
L4	109.33	S00°27'02"W
L5	79.03	S00°27'02"W
L6	28.53	S89°32'58"E
L7	45.24	S89°32'58"E
L8	80.49	S89°32'58"E

J.E. WHITE SUBDIVISION NO. 2

Florence Ave.

N 01°01'14" E 627.51'

UNPLATTED

10'

HEALTH CERTIFICATE

Sanitary restrictions as required by Idaho Code Title 50, Chapter 13, have been satisfied. Sanitary Restrictions may be reimposed, in accordance with Idaho Code Title 50, Chapter 13, Section 50-1326, by the issuance of a certificate of disapproval.

Date: Apr. 30, 2003 219
South Central District Health Dept., EHS

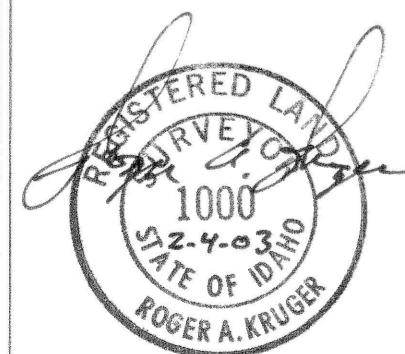

REAL POINT OF BEGINNING



FOUND BRASS CAP
CP # 1994007358

S 89°32'58" E 1327.51'
BASE OF BEARING - INSTRUMENT # 950175

CRAWFORD ADDITION

FOUND 5/8 REBAR WITH JUB CAP

LOCATED IN
A PORTION OF
SE⁴SW⁴SW⁴ SECTION 3
TOWNSHIP 10 SOUTH
RANGE 17 EAST
BOISE MERIDIAN
TWIN FALLS COUNTY
IDAHO 2003

Legend:

- Boundary Line
- Utility, Drainage, & Access Easement
- Utility, Drainage, & Irrigation Easement
- Center Line of Street
- Set 1/2"x24" Rebar and Cap (LS 1000)
- Set 5/8"x30" Rebar and Cap (LS 1000)
- Found 5/8" Rebar set Cap (LS 1000)

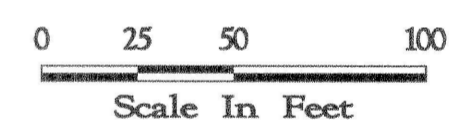

Notes:

1. BUILDING SETBACKS:
 - A. 80' FROM CENTER LINE OF FALLS AVENUE EAST.
 - B. 72' FROM CENTER LINE OF LOCUST STREET NORTH

Twin Falls County, Idaho
Registered Land Surveyors
E.H.M. ENGINEERS
09:27am Mar. 18, 2003
2003 - 006654
No. of Pages: 2 Fee: \$22.00
ROBERT S. FOSTER, Esq.
Ex-Officio Recorder
Deputy: JF

E.H.M. Engineers, Inc.
ENGINEERS/SURVEYORS/PLANNERS