

C FUNCTIONS - CURVE NO. 1  
 $I = 61^{\circ}37'$  -  $R = 192.70'$  -  $T = 114.90'$   
 $D = 29^{\circ}44.1'$  -  $LC = 197.38'$  -  $ARC = 207.23'$   
 INSIDE ARC - CURVE NO. 2  
 $I = 61^{\circ}37'$  -  $R = 83.84'$  -  $T = 50.0'$   
 $D = 68.32^{\circ}$  -  $LC = 85.88'$  -  $ARC = 90.19'$   
 LOT CORINERS - 1/2" X 24" IRON RODS  
 BLOCK CORNERS - 5/8" X 30" IRON RODS

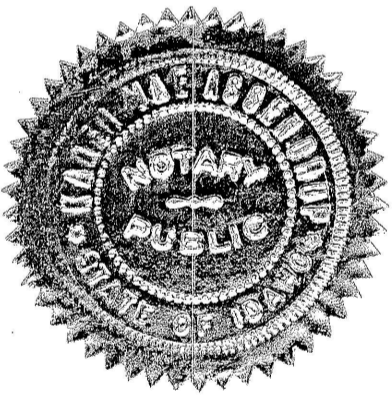

**COLLEGE TERRACE SUBDIVISION**  
 IN NE<sup>4</sup>NW<sup>4</sup> of SEC. 11, T. 10 S., R. 17 E., B. M.  
 TWIN FALLS COUNTY, IDAHO

**DEDICATION**

This is to certify that the undersigned are owners in fee simple of the property herein described; that the correct description of the land in this plat is as follows:  
 A tract of land in the NE<sup>4</sup> NW<sup>4</sup> of SEC. 11, T. 10 S., R. 17 E., B. M., Twin Falls Co., Idaho; Beginning at the northwest corner of said NE<sup>4</sup> NW<sup>4</sup>; Thence S 0°12' E, 1150.0 feet; Thence S 88°46' E, 170.0 feet; Thence N 0°12' W, 335.0 feet; Thence N 44°17' E, 239.24 feet; Thence N 36°21' E, 115.90 feet; Thence N 38°06' E, 109.35 feet; Thence N 43°07' E, 102.84 feet; Thence N 31°53' E, 100.14 feet; Thence N 36°07' E, 128.0 feet; Thence S 88°46' E, 213.85 feet; Thence N 0°12' W, 190.0 feet; Thence N 88°46' W, 888.0 feet to the point of beginning.  
 That it is the intention of the undersigned to and they do hereby include said land in this plat; That the undersigned owners, do by these presents grants, bargain, sell, convey, confirm and dedicate to the public, for public use forever, all streets, thoroughfares, alleys and parks as shown on this plat.

TWIN FALLS TITLE & TRUST CO., TRUSTEE

BY: Gordon Gray President  
Karl C. Freeman  
Betty J. Freeman  
Don E. Mitton  
Shirley Mitton  
 Owners of Lot 2  
 Block 2

ATTEST: R. L. Smith Assistant Secretary  
Shirley Mitton Owners of Lot 2 Block 2

**ACKNOWLEDGMENT**

STATE OF IDAHO )  
 County of Twin Falls ) ss  
 On this 10<sup>th</sup> day of May, 1966, before me, a Notary Public in and for said State, personally appeared GORDON GRAY and R. L. SMITH, known to me to be the President and Assistant Secretary of the corporation that executed this instrument or the persons who executed the instrument on behalf of said corporation, and acknowledged to me that such corporation executed the same, as trustee.  
 IN WITNESS WHEREOF, I have hereunto set my hand and affixed my official seal the day and year in this certificate first above written.

Karen Mae Casandrup  
 Notary Public  
 My Comm. expires April 1, 1968

**ACKNOWLEDGMENT**

STATE OF IDAHO, County of Twin Falls )  
 On this 10<sup>th</sup> day of May, 1966, before me, a Notary Public in and for said State, personally appeared KARL C. FREEMAN, BETTY J. FREEMAN, DON E. MITTON and SHIRLEY MITTON, known to me to be the persons whose names are subscribed to the within instrument, and acknowledged to me that they executed the same.

Karen Mae Casandrup  
 Notary Public  
 My Comm. expires April 1, 1968

**SURVEYOR'S CERTIFICATE**

This is to certify that I, Orvie A. Jensen, a duly qualified Land Surveyor, surveyed the land described in the foregoing dedication; and that this plat is a true and correct representation of said survey as made and staked by me on said land, and designated herein as "COLLEGE TERRACE SUBDIVISION."

Orvie A. Jensen  
 Registered Land Surveyor  
 S-693  
 STATE OF IDAHO  
 ORVIE A. JENSEN

**ACKNOWLEDGMENT**

STATE OF IDAHO )  
 County of Jerome ) ss  
 On this 9 day of May 1966, before me, a Notary Public in and for said State, personally appeared Orvie A. Jensen, known to me to be the person whose name is subscribed to the foregoing Surveyor's Certificate, and acknowledged to me that he executed the same.

IN WITNESS WHEREOF, I have hereunto set my hand and affixed my official seal the day and year in this certificate first above written.

Orvie A. Jensen  
 Notary Public  
 My Comm. expires 4-1-70

**CITY ENGINEER'S APPROVAL**

The undersigned hereby certifies that the property described in this plat lies within one mile of the City of Twin Falls, Idaho, and that this plat has been examined by the undersigned, and is in all respects approved.  
 Dated this 6<sup>th</sup> day of June, 1966.

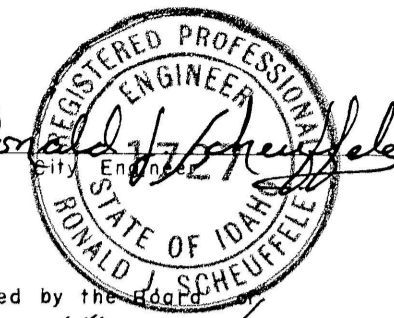
  
 City Clerk  
  
 Registered Professional Engineer  
 State of Idaho  
 Ronald J. Scheuffele  
 City Engineer

**COUNTY COMMISSIONER'S ACCEPTANCE**

The foregoing plat was duly accepted and approved by the Board of Commissioners of the County of Twin Falls, Idaho, on the 7 day of June, 1966.  
H. A. Lancaster Clerk  
Morris W. Carlson Chairman  
 Plat No. 565056

**COUNTY RECORDER'S CERTIFICATE**

This is to certify that the foregoing plat was filed for record in the office of the Recorder of Twin Falls County, Idaho, this 7 day of June, 1966 at 1:00 P.M. at the request of City Clerk and duly recorded in Plat Book No. 93 at page 19.

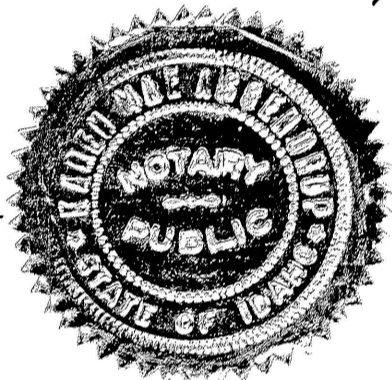

H. A. LANCASTER  
 Ex-Officio Recorder

Deputy  
 Deputy

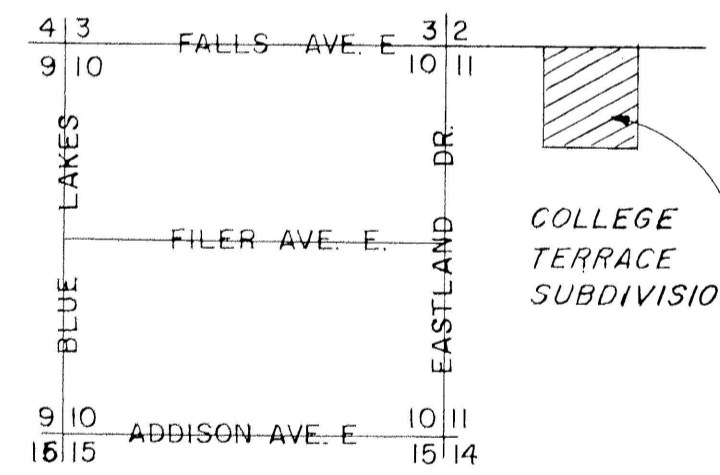

VICINITY MAP  
 2 in. = 1 mi.

Twin Falls County, Idaho  
 Recorded for:  
 JENSEN, ORVIE A.  
 09:00:00 am Jun. 07, 1966  
 0000 - 565056